

FRANKLIN



- Geophysical seabed mapping
- ROV Operations
- Geotechnical sampling
- Environmental assignments

FRANKLIN



TYPE OF VESSEL

DP1 Survey & ROV Vessel

SPECIFICATIONS

| | |
|-------------------|--|
| Flag: | Faroe Island |
| Class: | 1A Offshore service vessel, DYNPOS (AUT) EO SPS or: Research / Survey Vessel |
| Call sign: | OZ2102 |
| Home port: | Tórshavn |

BUILDER & DIMENSIONS

| | |
|----------------------------------|--|
| Built: | North Queensland Engineers & Agents Pty. Ltd. in 1985 |
| Gross tonnage: | 1178 tons |
| Net tonnage: | 353 tons |
| Dead weight: | 1.218 tons |
| LOA: | 55.61 m |
| Breadth: | 11.99 m |
| Draft: | 4.20 m |
| Req. water depth w. Azim: | 6.00m |
| Service Speed: | 12 kts |
| Max speed: | 13.5 kts |

PROPULSION:

| | |
|------------------------|--|
| Main Engines: | Single Wärtsilä 12V22MD, 1590 kW at 900 rpm Single Lips BV CPP propeller |
| Bow thruster: | Retractable azimuth 295 kW, 5.3 ton |
| Stern thruster: | one tunnel thruster 295Kw, 4.5 ton |

Station holding capacity: DP class 1

POWER SUPPLY:

| | |
|---------------------------|---|
| Shaft generator | 800kVA |
| Diesel generators: | 2x375 kVA Volvo Penta D12 415V 50 Hz 3 phase 240 V 50 Hz, UPS available |

DECK EQUIPMENT

| | |
|-------------------------|-------------------------------|
| A-Frames Stern: | 8mt |
| Over-the-side: | 2.8 mt (wire depending) |
| Deck crane SWL: | 11m, 2.7 mt |
| Free Deck Space: | approx..85m2, 3x20' container |

NAVIGATION/COMMUNICATION EQUIPMENT

| | |
|--------------------------------|---|
| Radar: | Furuno 2117, Transas Naviradar 4000 |
| ECDIS: | Transas NS 4100 |
| GMDSS A3 | |
| V-Sat (Internet, phone) | |
| Sat TV | |
| Obstacle Avoidance | |
| Sonar: | Furuno |
| Winches: | 18 mm rotation free wire 900m, SWL 6 mt 10.0 mm signal FO wire 2100 m |
| Generators: | 2 Volvo Penta D12 genset, 375 kVA each one shaft generator 800 kVA |

WORK SPACES:

Wet lab
Chemistry lab
Post-processing room
Separate client office
General purpose lab
Survey Room

ACCOMMODATION:

12 single cabins, 18 double cabins
Mess room, Day Room, Dressing
Room, Two Laundries, Hospital,
Gymnasium

NAVIGATION AND POSITIONING

| | |
|--------------------------------------|--|
| Primary Positioning System: | POS MV 320 with C-Nav C2, IALA DGPS corrections and RTK option |
| Secondary Positioning System: | Crescent Hemisphere with IALA DGPS corrections |
| Optional Positioning System: | C-Nav 3050 with C1 correction C-Nav 3050 with C2 correction |
| Gyro/Motion: | Applanix POS MV 320 |
| Underwater positioning USBL: | IXSEA GAPS III |
| Survey Navigation System: | QPS QINSy |
| Sound Velocity Profiler: | Valeport MiniSVS, Valeport Midas SVX2 |
| Hull mounted Sound | |
| Velocity Sensor: | Valeport MiniSVS |

BATHYMETRY AND GEOPHYSICS:

| | |
|---|---|
| Multibeam Echo Sounder: | |
| | Kongsberg EM 2040D Kongsberg EM 710 |
| Side Scan Sonar: | Edgetech 4200MP, 300/600 kHz or 300/900 kHz Edgetech 2000-CSS, 300/600 kHz or 300/900 kHz |
| Sub-bottom Profiler: | Innomar 2000 SES – 100 medium Edgetech DW 106 1-10 kHz Edgetech 512i 0.5-12 kHz Sparker/Boomer |
| High resolution seismic sparker and streamers for 2D and 3D operations | |
| | Geo-Sense Multi channel Stremers 48 channels Geo Source Sparker Systems |

Magnetometer survey spread:

| |
|---|
| Towfish with TGV frame 2xMacArtney FOCUS 2 |
| ROTV with TVG frame |
| 2xScanFish Katria with 8 Geometrics G-882 |

OFF-LINE SOFTWARE:

| |
|------------------------------|
| Chesapeake SonarWiz |
| SMT Kingdom |
| Oasis Montaj incl OXU Marine |
| QPS/IVS Processing Suite |
| CARIS HIPS & SIPS |
| POSPac MMS |
| TerraPos |
| IXSEA DelphINS |
| Autodesk AutoCAD Map 3D |
| Arc GIS |
| Wish software Autochart |
| Visual Soft Visual Works |
| EIVA NaviSuite |

SEAFLOOR SAMPLING AND UNDERWATER INSPECTION:

| | |
|---------------------|----------------------------|
| ROV: | Sub-Atalantic Mohican |
| ROTV: | MacArtney FOCUS 2 |
| Vibrocorer: | 6/3 m system |
| Corers: | Piston/gravity corer 6/3 m |
| Samplers: | Boxcorer/grabsampler |
| PCPT: | Neptune 5000 |
| Drop Camera: | STR Seaspyder Drop Camera |

FRANKLIN

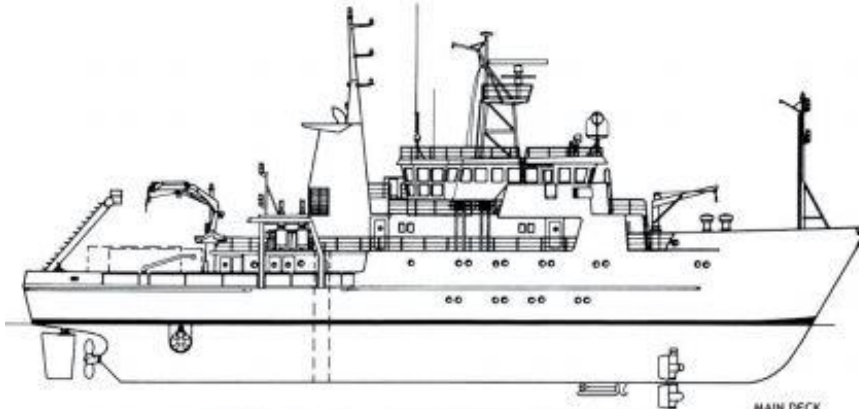

MAIN DECK

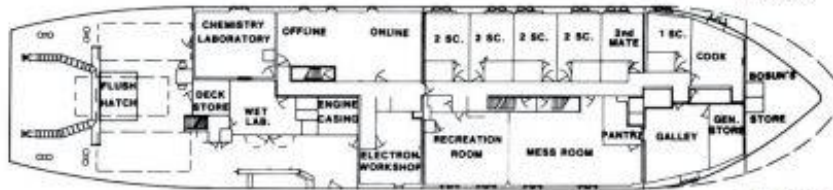

TWEEN DECK

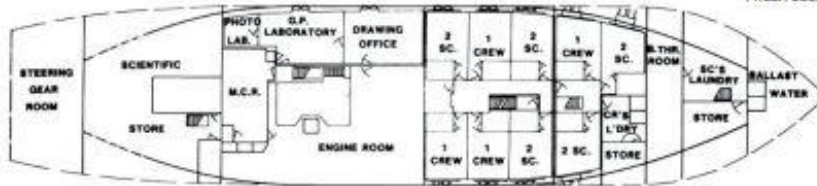

BOTTOM

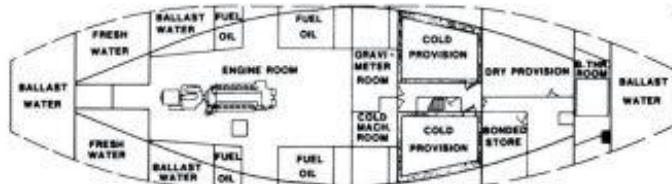

BRIDGE DECK/BOAT DECK

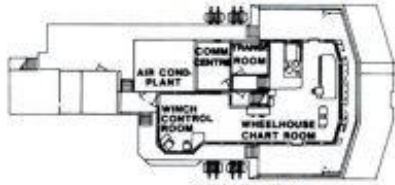

FORECASTLE DECK

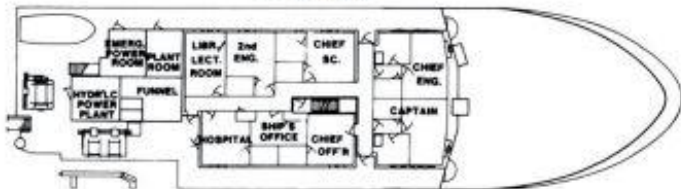

SPECIFICATIONS

- Flag:**
Faroe Islands
- Port of Registry:**
Torshavn
- Call Sign:**
OZ2102
- IMO No:**
8301797
- Class:**
DNV-GL
- Class Notation:**
1A Offshore service vessel
DYNPOS(AUT) E0 SPS